

CODIGO **08730**

DESCRIPCION: **BASE CON RUEDAS SILLA SOCORRISTA**

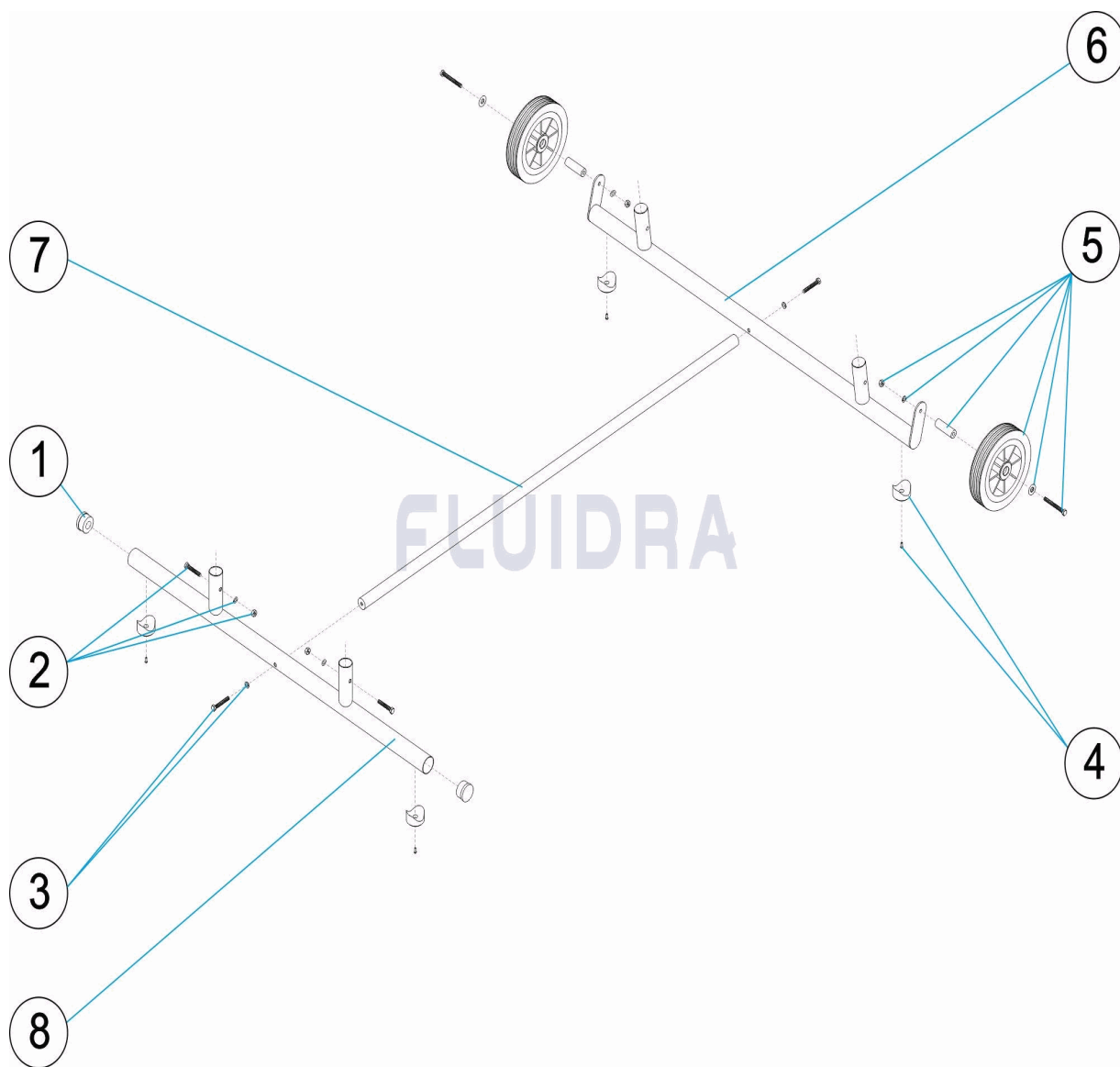

**ESPAÑOL**

| POS | CODIGO     | DESCRIPCION                  | CANTIDAD | POS | CODIGO     | DESCRIPCION            | CANTIDAD |
|-----|------------|------------------------------|----------|-----|------------|------------------------|----------|
| 1   | 4401070208 | TAPON D.43                   |          | 5   | 4401070209 | RUEDA SILLA SOCORRISTA |          |
| 2   | 4401030104 | TORNILLERIA FIJACION SOPORTE |          | 6   | 08730R0300 | TUBO TRASERO           |          |
| 3   | 4401070029 | TORNILLERIA FIJACION         |          | 7   | 08730R0100 | TUBO CENTRAL           |          |
| 4   | 4401070018 | ANILLO CONCAVO               |          | 8   | 08730R0200 | TUBO DELANTERO         |          |

CODE 08730

DESCRIPTION: BASE AVEC ROUES FAUTEUIL DE SURVEILLANCE

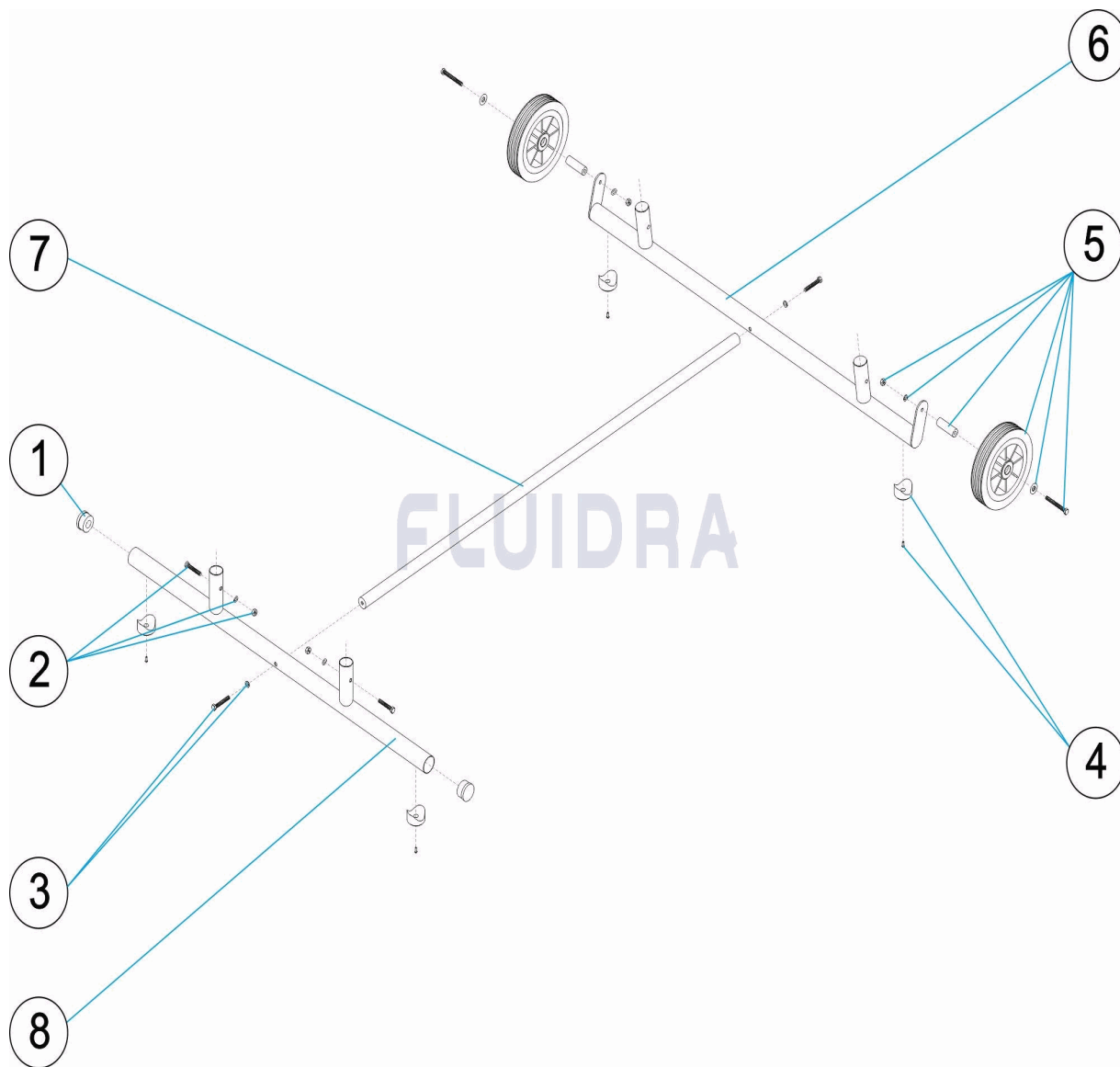

FRANCAIS

| POS | CODE       | DESCRIPTION                | QUANTITE | POS | CODE       | DESCRIPTION              | QUANTITE |
|-----|------------|----------------------------|----------|-----|------------|--------------------------|----------|
| 1   | 4401070208 | BOUCHON D.43               |          | 5   | 4401070209 | ROUE FAUTEUIL SECOURISTE |          |
| 2   | 4401030104 | VIS DE FIXATION DU SUPPORT |          | 6   | 08730R0300 | TUBE ARRIERE             |          |
| 3   | 4401070029 | VIS DE FIXATION            |          | 7   | 08730R0100 | TUBE CENTRAL             |          |
| 4   | 4401070018 | ANNEAU FIXATION            |          | 8   | 08730R0200 | TUBE AVANT               |          |

CODE **08730**

DESCRIPTION: **LIFEGUARD CHAIR BASE WITH WHEELS**

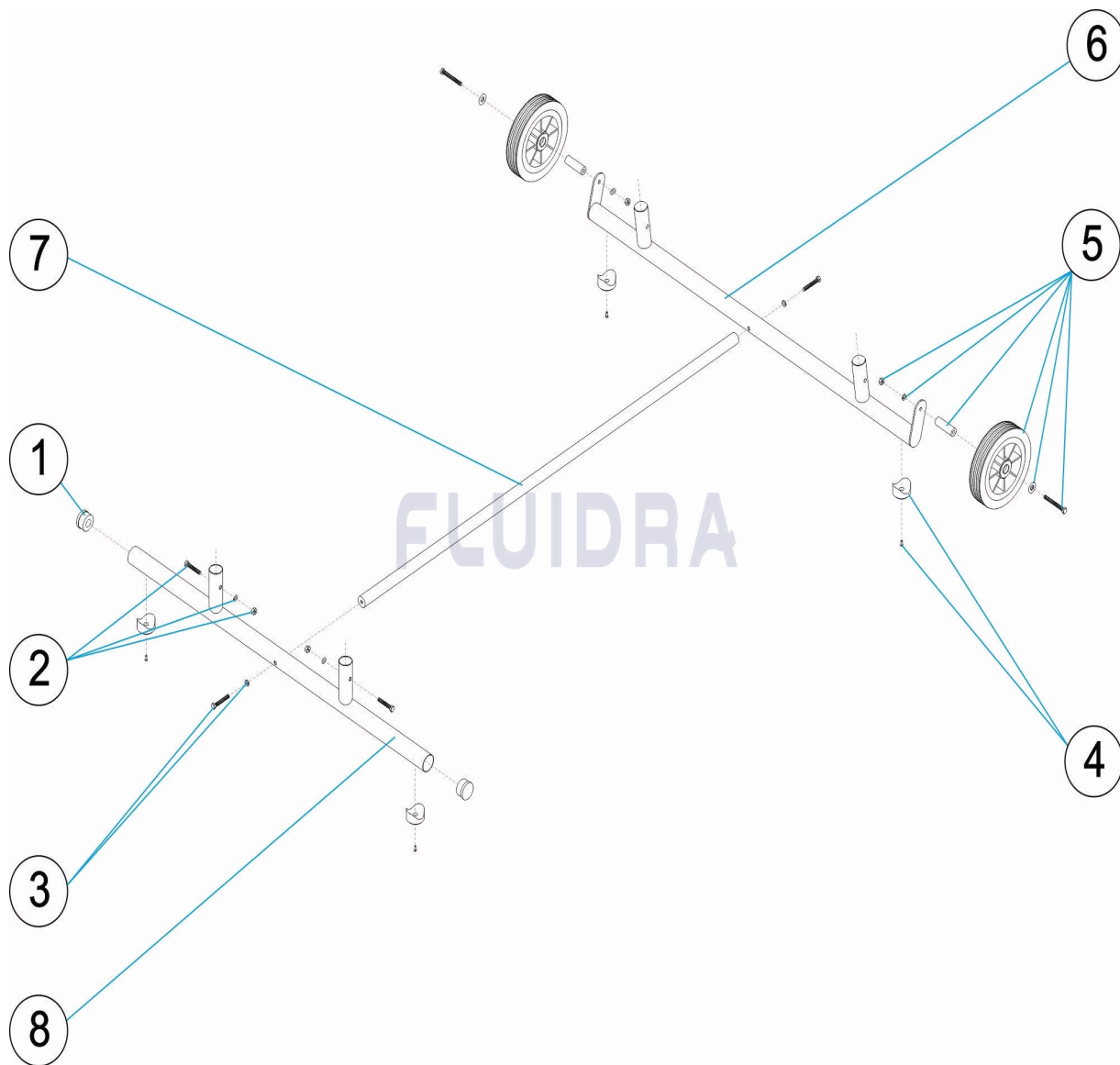

**ENGLISH**

| POS | CODE       | DESCRIPTION      | QUANTITY | POS | CODE       | DESCRIPTION     | QUANTITY |
|-----|------------|------------------|----------|-----|------------|-----------------|----------|
| 1   | 4401070208 | PLUG D.43        |          | 5   | 4401070209 | LIFEGUARD WHEEL |          |
| 2   | 4401030104 | SUPPORT BOLT SET |          | 6   | 08730R0300 | BACK TUBE       |          |
| 3   | 4401070029 | BOLT SET         |          | 7   | 08730R0100 | CENTRAL TUBE    |          |
| 4   | 4401070018 | SHOE RING        |          | 8   | 08730R0200 | FRONT TUBE      |          |

CODICE **08730**

DESCRIZIONE: **BASE CON RUOTE SEDIA BAGNINO**

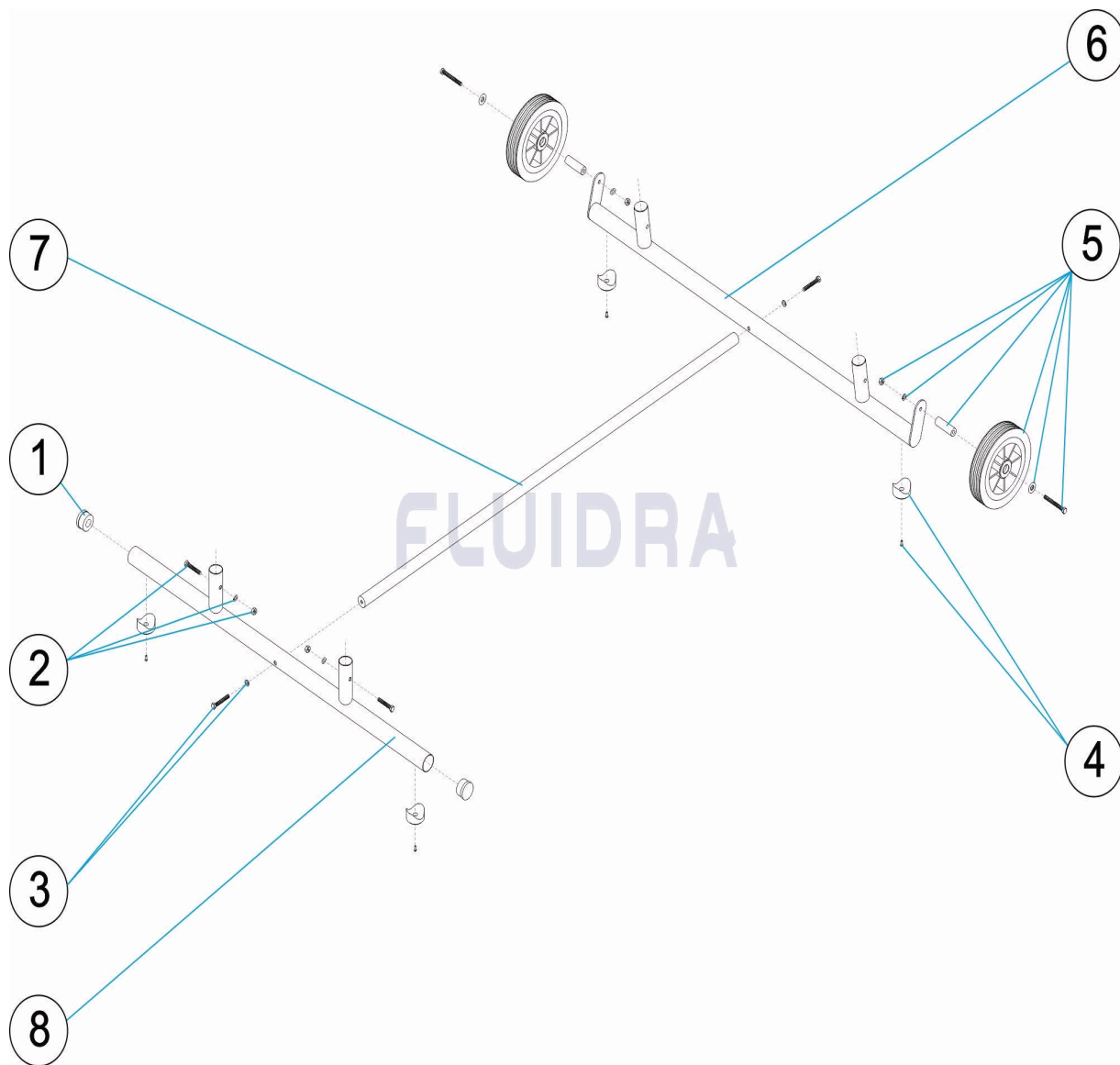

**ITALIANO**

| POS | CODICE     | DESCRIZIONE                       | QUANTITA' | POS | CODICE     | DESCRIZIONE                 | QUANTITA' |
|-----|------------|-----------------------------------|-----------|-----|------------|-----------------------------|-----------|
| 1   | 4401070208 | TAPPO D.43                        |           | 5   | 4401070209 | RUOTA PIATTAFORMA VIGILANZA |           |
| 2   | 4401030104 | BULLONERIA PER FISSAGGIO SUPPORTO |           | 6   | 08730R0300 | TUBO POSTERIORE             |           |
| 3   | 4401070029 | BULLONERIA PER FISSAGGIO          |           | 7   | 08730R0100 | TUBO CENTRALE               |           |
| 4   | 4401070018 | ANELLO FISSAGGIO                  |           | 8   | 08730R0200 | TUBO ANTERIORE              |           |

CODE **08730**

BESCHREIBUNG: **BASIS MIT RÄNDERN RETTUNGSSCHWIMMERSITZ**

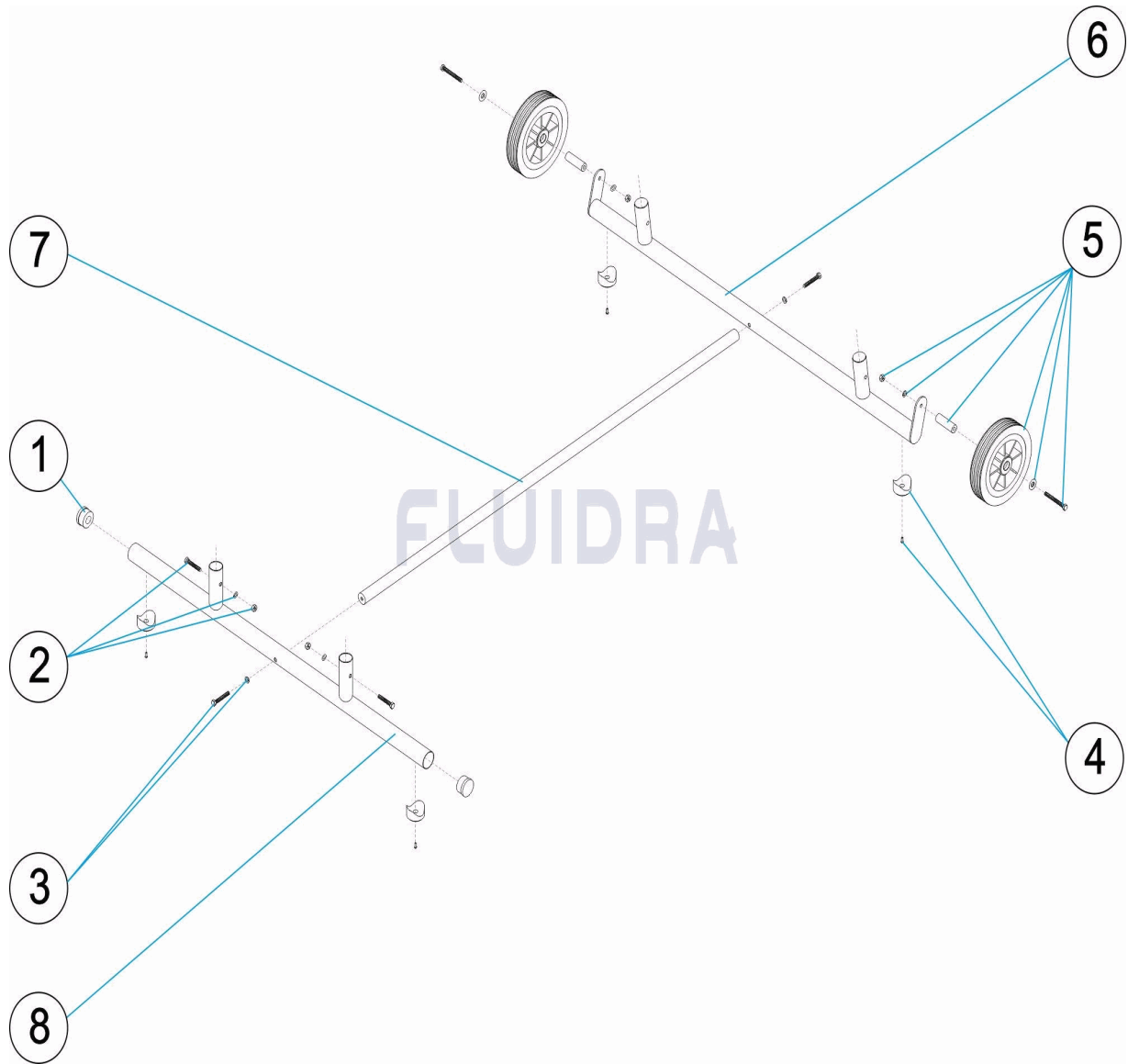

**DEUTSCH**

| POS | CODE       | BESCHREIBUNG              | MENGE | POS | CODE       | BESCHREIBUNG              | MENGE |
|-----|------------|---------------------------|-------|-----|------------|---------------------------|-------|
| 1   | 4401070208 | STOPFEN D.43              |       | 5   | 4401070209 | RAD RETTUNGSSCHWIMMERSITZ |       |
| 2   | 4401030104 | FIXIERSCHRAUBEN HALTERUNG |       | 6   | 08730R0300 | ROHR HINTEN               |       |
| 3   | 4401070029 | FIXIERSCHRAUBEN           |       | 7   | 08730R0100 | MITTLERES ROHR            |       |
| 4   | 4401070018 | KONKAVER RING             |       | 8   | 08730R0200 | ROHR VORNE                |       |

CODIGO **08730**

DESCRIÇÃO: **BASE COM RODAS CADEIRA SOCORRISTA**

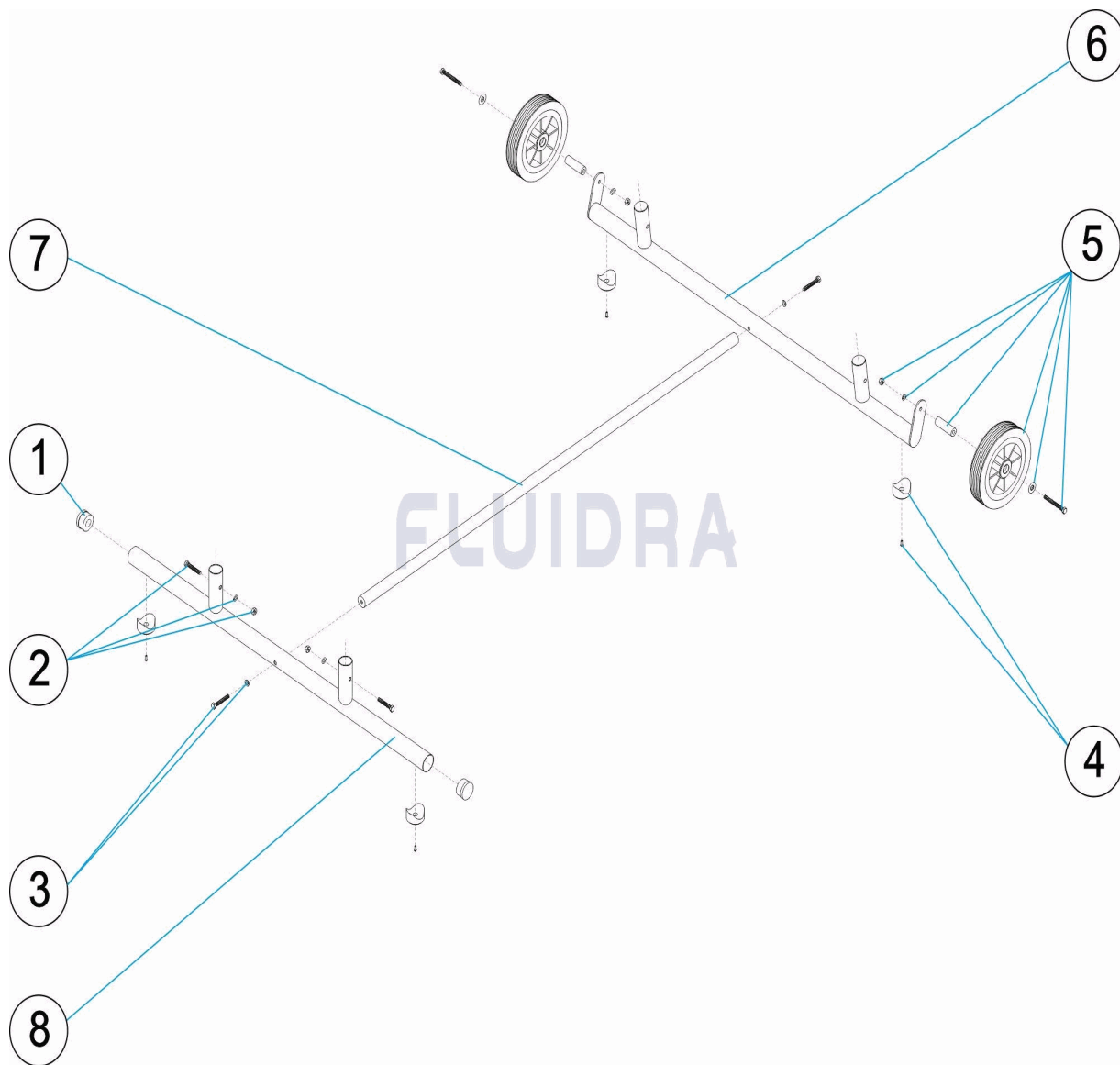

**PORTUGUES**

| POS | CODIGO     | DESCRIÇÃO               | JANTIDADE | POS | CODIGO     | DESCRIÇÃO                | JANTIDADE |
|-----|------------|-------------------------|-----------|-----|------------|--------------------------|-----------|
| 1   | 4401070208 | TAMPÃO D.43             |           | 5   | 4401070209 | RODAS CADEIRA SOCORRISTA |           |
| 2   | 4401030104 | CONJ. PARAFUSOS SUPORTE |           | 6   | 08730R0300 | TUBO TRASEIRO            |           |
| 3   | 4401070029 | CONJ. PARAFUSOS         |           | 7   | 08730R0100 | TUBO CENTRAL             |           |
| 4   | 4401070018 | ANEL DE FIXAÇÃO         |           | 8   | 08730R0200 | TUBO DIANTEIRO           |           |