

CODIGO **07331, 18243**

DESCRIPCION: **ANCLAJE DESMONTABLE CON PLETINA AISI-316**

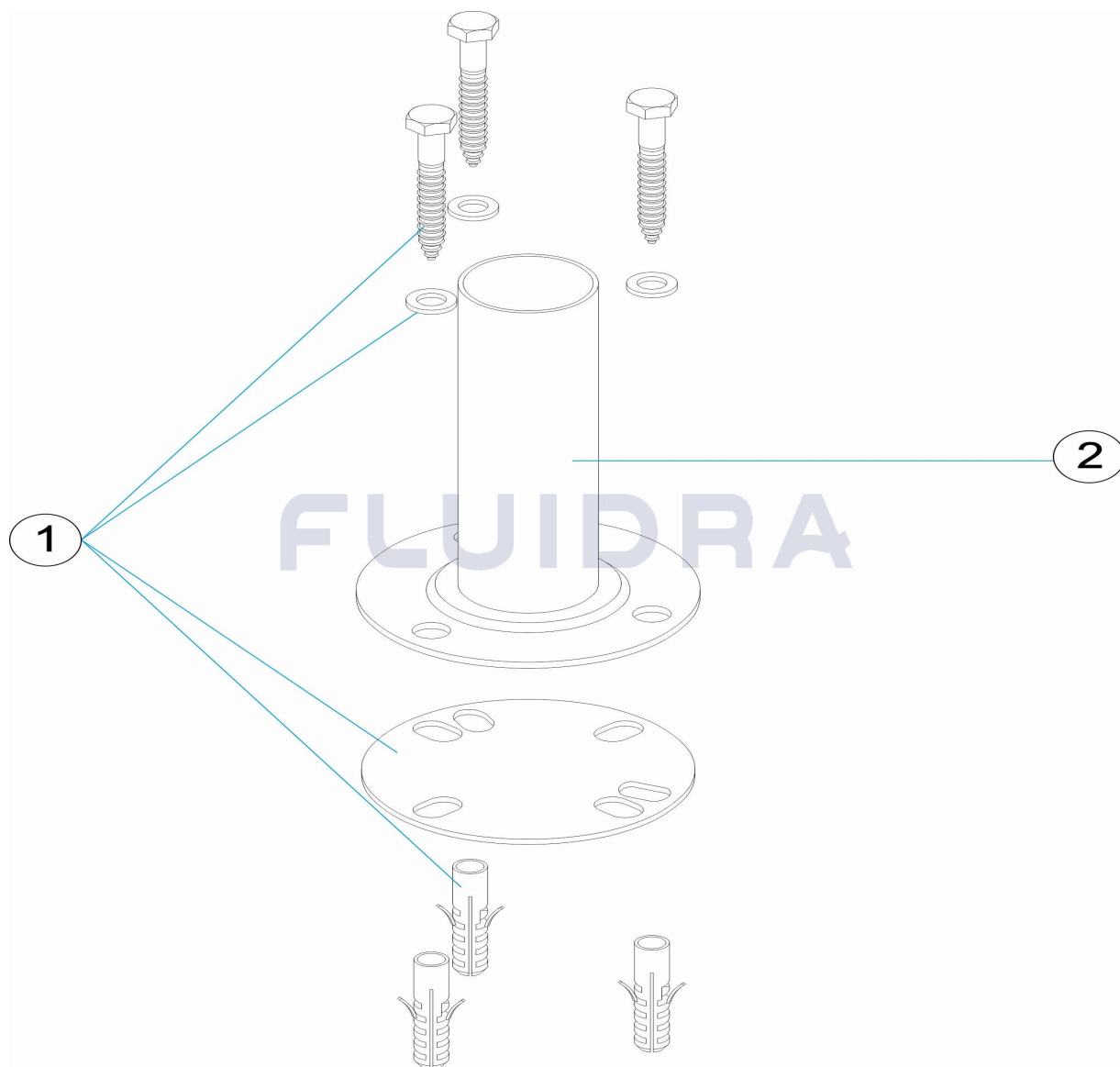

ESPAÑOL

POS	CODIGO	DESCRIPCION	CANTIDAD	POS	CODIGO	DESCRIPCION	CANTIDAD
1	4401091002	TORNILLERIA FIJACION ANCLAJE 316		2	18243R0100	ANCLAJE REFORZADO CON PLETINA	
2	07331R0100	ANCLAJE CON PLETINA					

CODE **07331, 18243**

DESCRIPTION: **FIXATION DÉMONTABLE AVEC PLAQUETTE AISI-316**

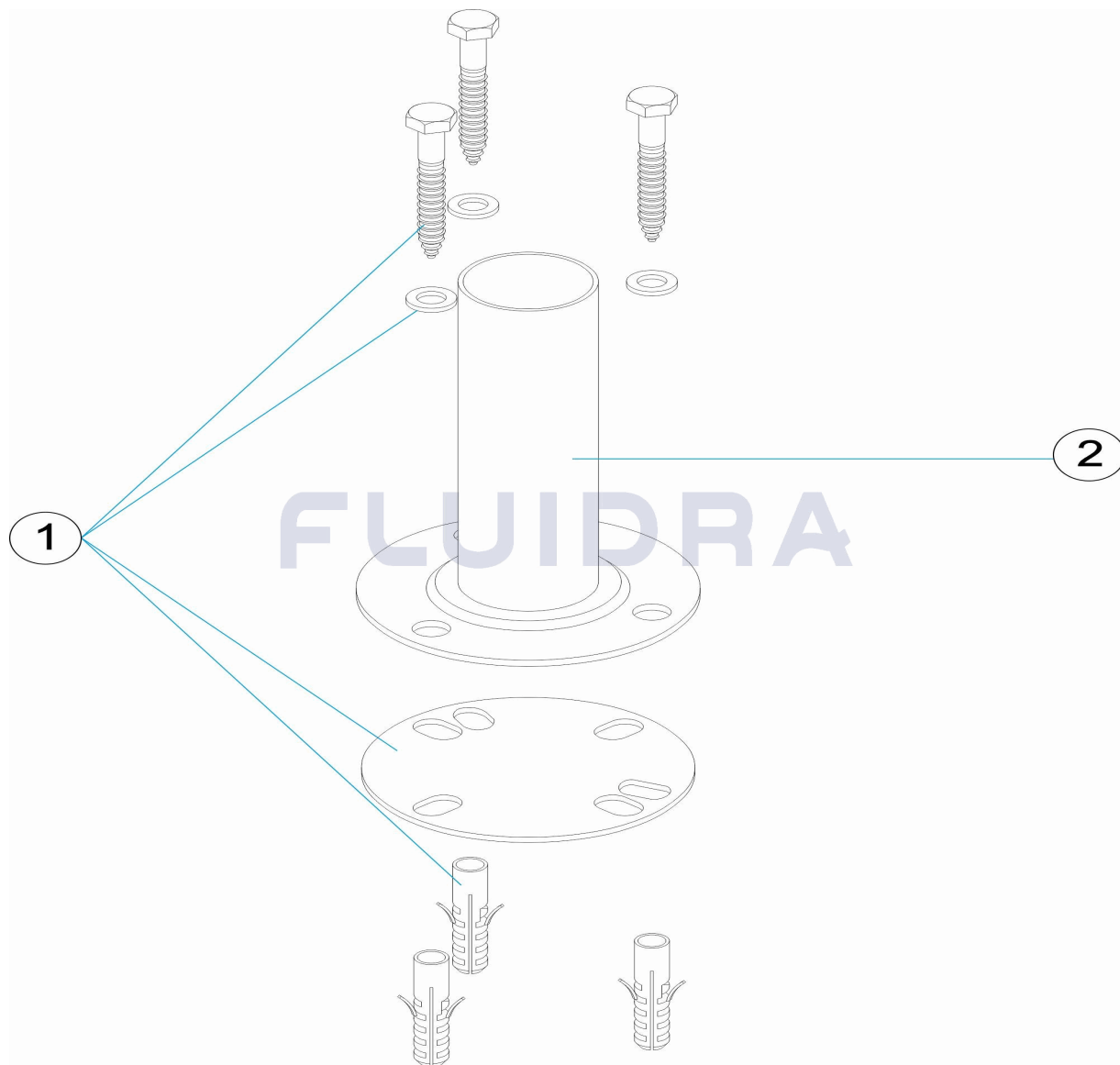

FRANCAIS

POS	CODE	DESCRIPTION	QUANTITE	POS	CODE	DESCRIPTION	QUANTITE
1	4401091002	VISSERIE FIXATION ANCRAGE 316		2	18243R0100	ANCRAGE AVEC PLATINE	
2	07331R0100	ANCRAGE AVEC PLATINE					

CODE **07331, 18243**

DESCRIPTION: **ANCHORING KIT AISI-316 WITH BASE PLATE**

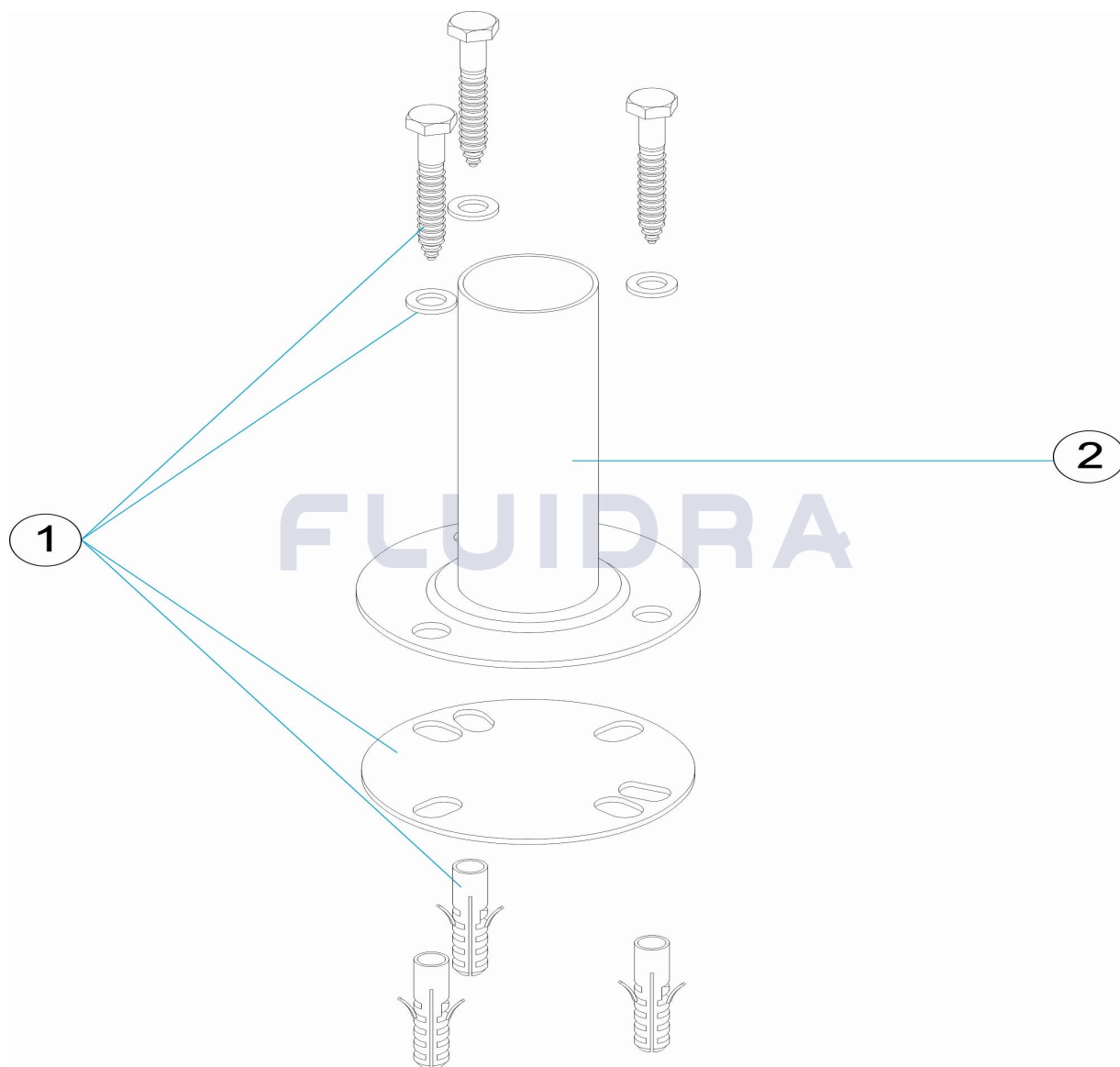

ENGLISH

POS	CODE	DESCRIPTION	QUANTITY	POS	CODE	DESCRIPTION	QUANTITY
1	4401091002	ANCHOR PLATE BOLTS 316		2	18243R0100	REINFORCED ANCHOR	
2	07331R0100	REINFORCED ANCHOR					

CODICE **07331, 18243**

DESCRIZIONE: **ANCORAGGIO SMONTABILE CON FLANGIA AISI-316**

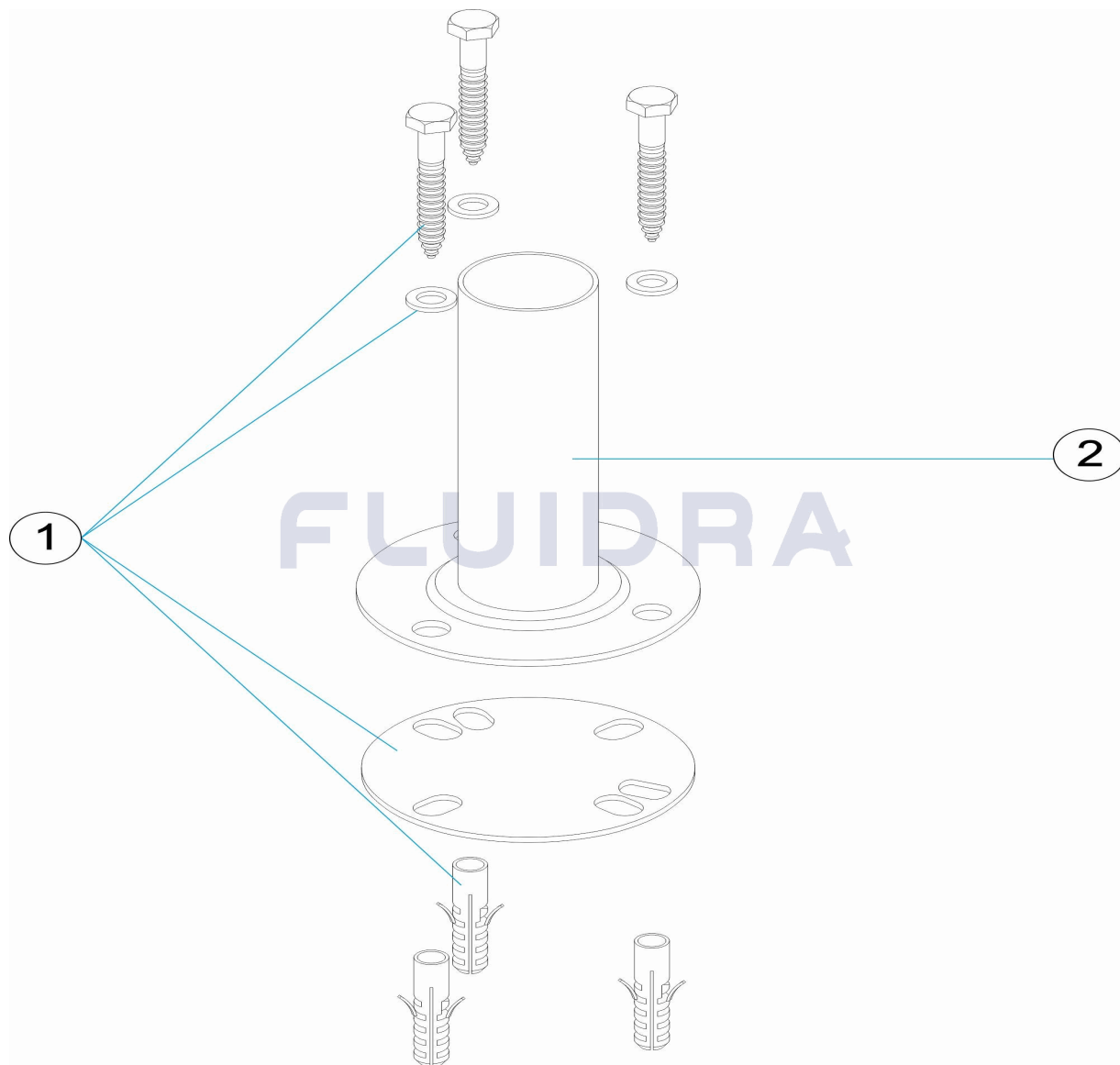

ITALIANO

POS	CODICE	DESCRIZIONE	QUANTITA'	POS	CODICE	DESCRIZIONE	QUANTITA'
1	4401091002	BULLONERIA FISSAGGIO ANCORAGGIO 3"		2	18243R0100	ANCORAGGIO CON PIATTINA	
2	07331R0100	ANCORAGGIO CON PIATTINA					

CODE **07331, 18243**

BESCHREIBUNG: **ABNEHMBARE VERANKERUNG MIT GRUNDPLATINE AISI-316**

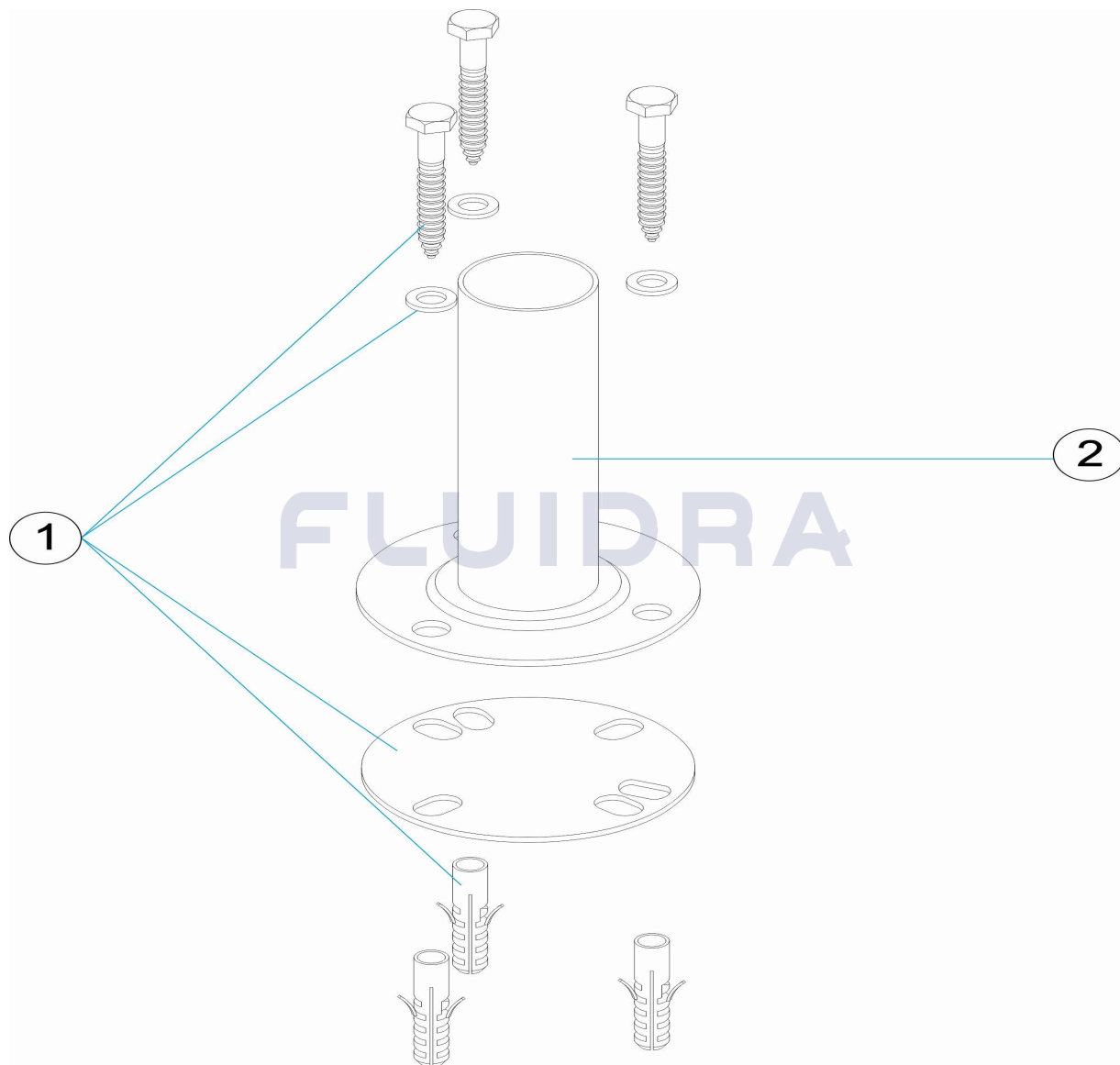

DEUTSCH

POS	CODE	BESCHREIBUNG	MENGE	POS	CODE	BESCHREIBUNG	MENGE
1	4401091002	FIXIERSCHRAUBEN VERANKERUNG 316		2	18243R0100	VERANKERUNG MIT GRUNDPLATINE	
2	07331R0100	VERANKERUNG MIT GRUNDPLATINE					

CODIGO **07331, 18243**

DESCRIÇÃO: **ANCORAGEM DESMONTÁVEL COM CHAPA AISI-316**

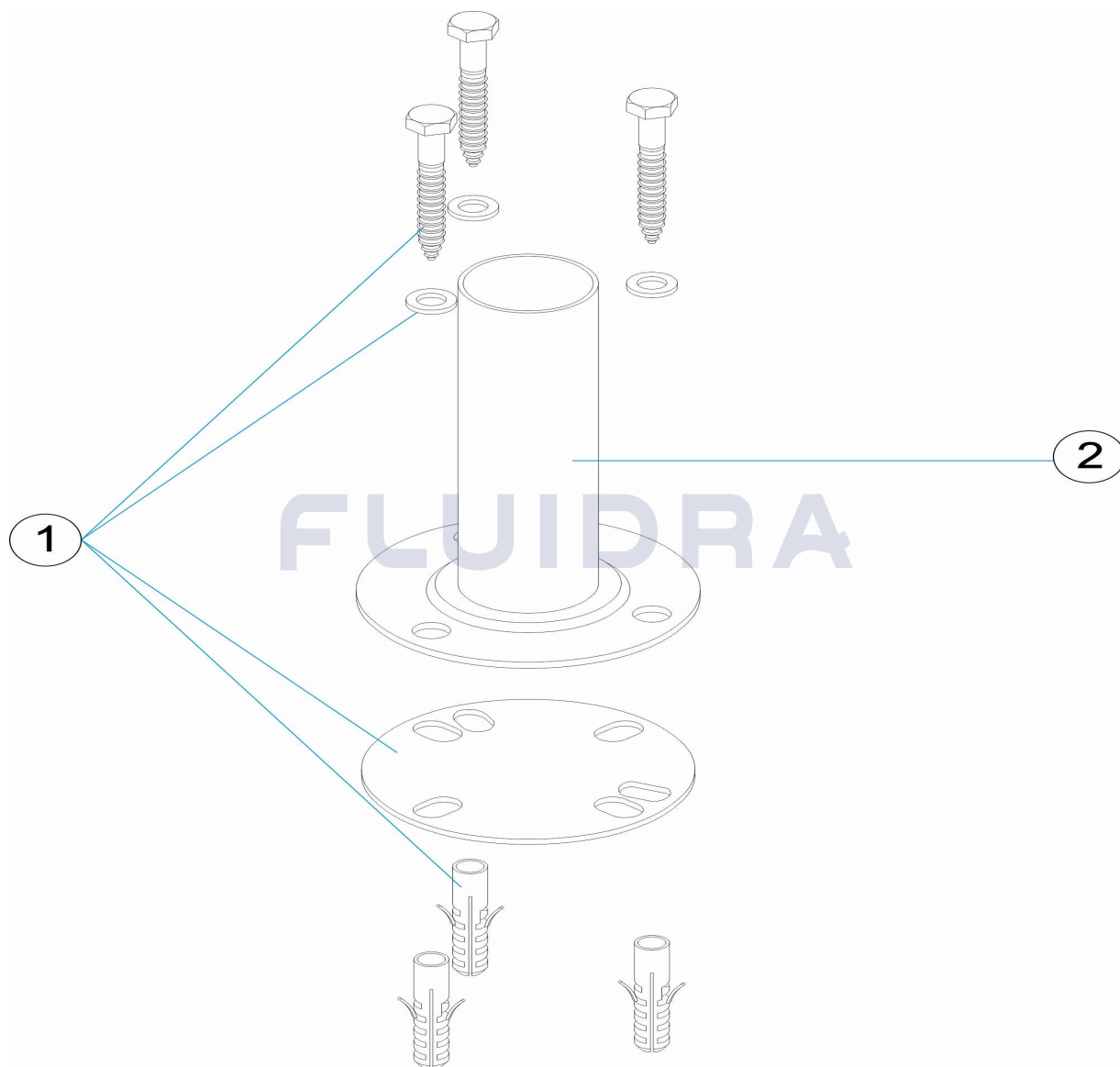

PORTUGUES

POS	CODIGO	DESCRIÇÃO	JANTIDADE	POS	CODIGO	DESCRIÇÃO	JANTIDADE
1	4401091002	CONJ.PARAFUSOS FIXAÇÃO ANCORAGEM		2	18243R0100	ANCORAGEM COM PLATINA	
2	07331R0100	ANCORAGEM COM PLATINA					